



**THIRD FLOOR, 38 FITZROY STREET
CAMBRIDGE, CB1 1EW**

TO LET | OFFICES: 2,200 SQ FT (204.38 SQ M)



BIDWELLS

LOCATION

The internationally renowned city of Cambridge is immersed in history and boasts one of the most vibrant economies in the UK and one of the world's leading education institutions.

The City has an extensive road network with the M11 providing a direct route to London and the M25, while the A14 dual carriageway links the city with the Midlands.

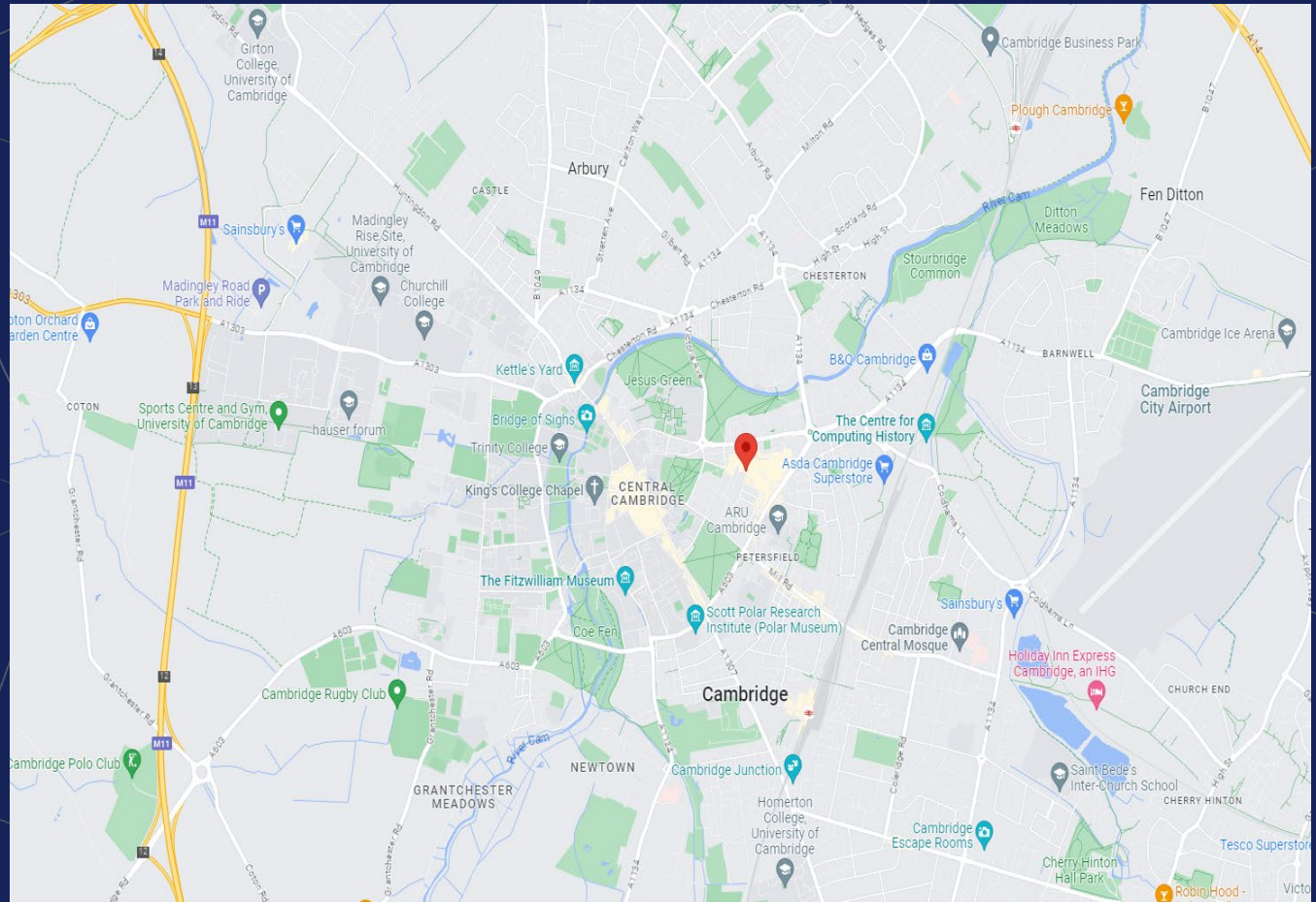
Cambridge is served by a mainline train station which provides a frequent service to London Kings Cross within 50 minutes. Additionally, trains to London Liverpool Street take as little as 1 hour 10 minutes making it a popular commuter destination.



SUMMARY



Description

The premise is situated on the busy retail thoroughfare of Fitzroy Street which draws shoppers into the 420,000 sq ft Grafton shopping centre a few yards away. Cambridge City Centre is only a short walk away as well as regular bus services running from the bus station on Drummer Street to and from the Grafton Centre.

The suite is available on the second floor of 38 Fitzroy Street above the Superdrug retail unit. There is private access to the upper floors via the City Road.

The property is newly refurbished and benefits from:

- Own dedicated ground floor entrance
- Climate control air conditioning
- Separate male and female WCs
- Excellent natural light
- Kitchen

Additional information

Terms

Available by way of a direct lease with the landlord.

Quoting rent available on application.

Rates

All interested parties are advised to make their own enquiries of Cambridge City Council on 01223 457 000.

Legal costs

All parties to bear their own legal costs.

Value added tax

All prices, premiums and rents etc. are quoted exclusive of VAT at the prevailing rate.

EPC

Available upon request.

Postcode

CB1 1EW

Part first floor

Sq ft	Sq m
2,200	204.38

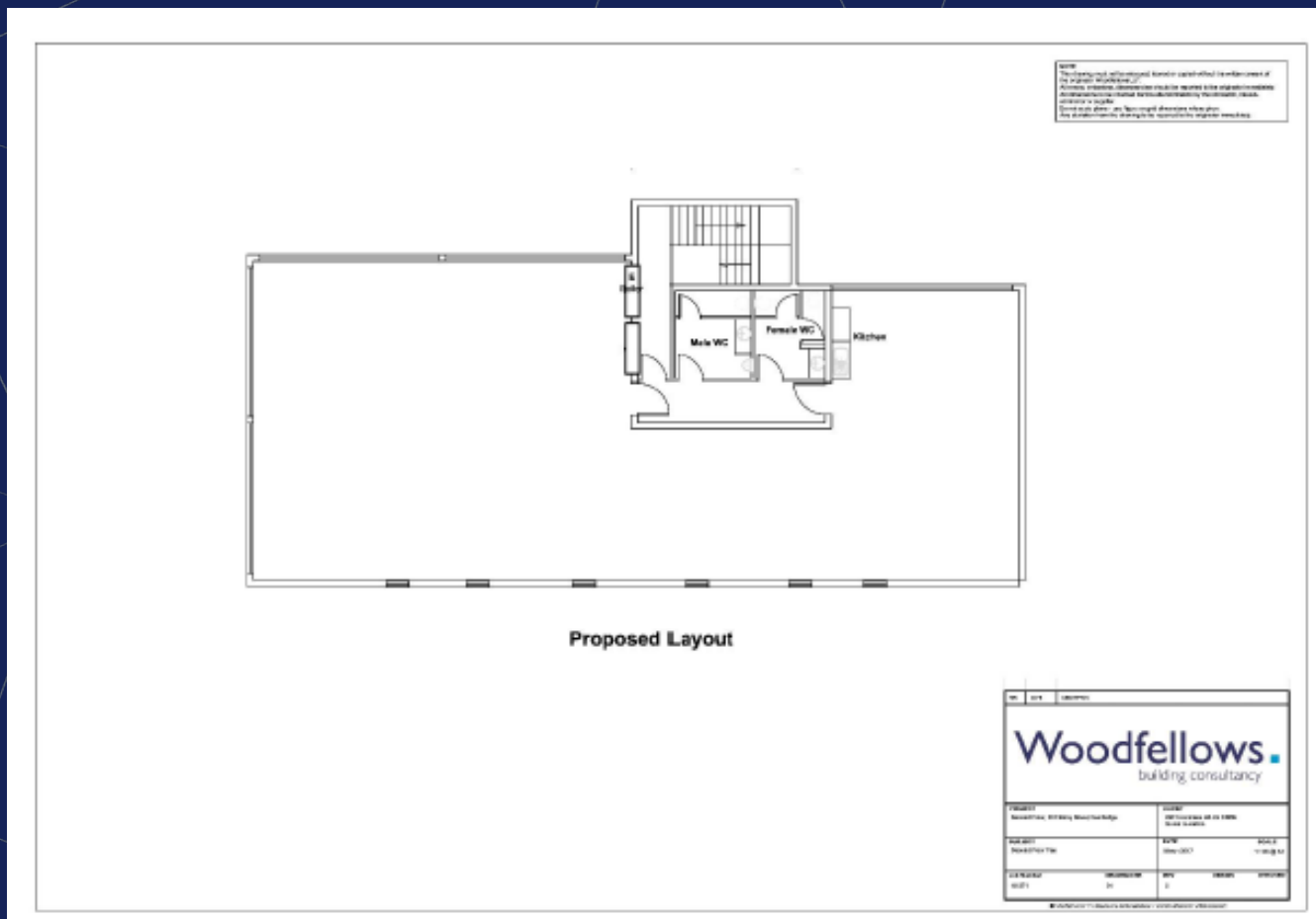

01223 841 841
bidwells.co.uk

BIDWELLS

GALLERY

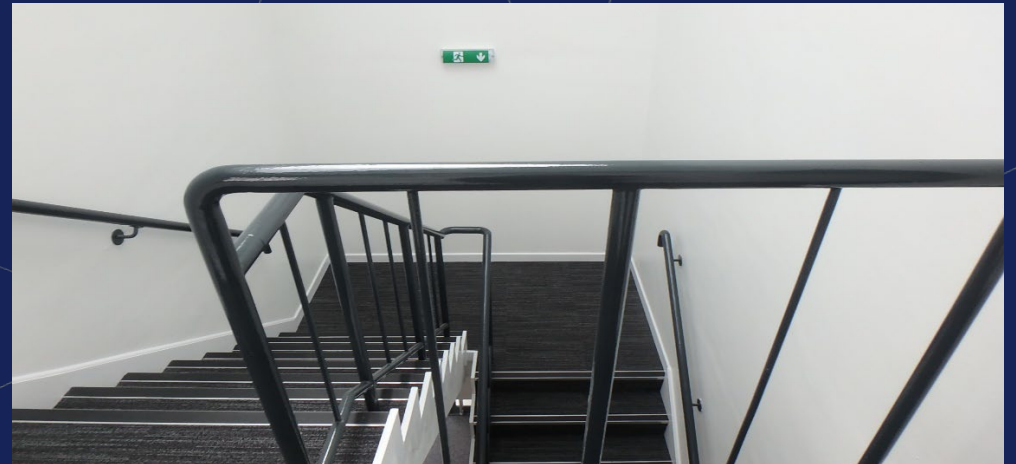

01223 841 841
bidwells.co.uk



Enquiries

Harry Blevins

07467 745 774

Harry.blevins@bidwells.co.uk

Tamarah Keir

07442 668 105

Tamarah.keir@bidwells.co.uk

Important notice

Bidwells LLP act for themselves and for the vendors/landlords of this property, whose agents they are, give notice that:

Nothing contained in these particulars or their contents or actions, both verbally or in writing, by Bidwells LLP form any offer or contract, liability or implied obligation to any applicants, viewing parties or prospective purchasers of the property to the fullest extent permitted by law and should not be relied upon as statements or representative of fact. No person in the employment of Bidwells LLP or any joint agents has authority to make or give any representation or warranty whatever in relation to this property. Any areas of measurements or distances are approximate. The text, photographs and plans are for guidance only, may not be to scale and are not necessarily comprehensive. No assumptions should be made that the property has all necessary planning, building regulation or other consents. Bidwells LLP has not carried out a survey, nor tested the services, appliances or facilities. Purchasers must satisfy themselves by inspection or otherwise. All rentals and prices are quoted exclusive of VAT unless otherwise stated.

Prospective purchasers and tenants will be asked to produce identification of the intended purchaser/tenant and other documentation in order to support any conditional offers submitted to the vendors. Bidwells LLP accepts no liability of any type arising from your delay or other lack of co-operation. We may hold your name on our database unless you instruct us otherwise.

OS licence no. ES 100017734. © Copyright Bidwells LLP 2017. Bidwells LLP is a limited liability partnership registered in England and Wales (registered number OC 344553). Registered office is Bidwell House, Trumpington Road, Cambridge CB2 9LD where a list of members is available for inspection. Your statutory rights are not affected by this notice.